

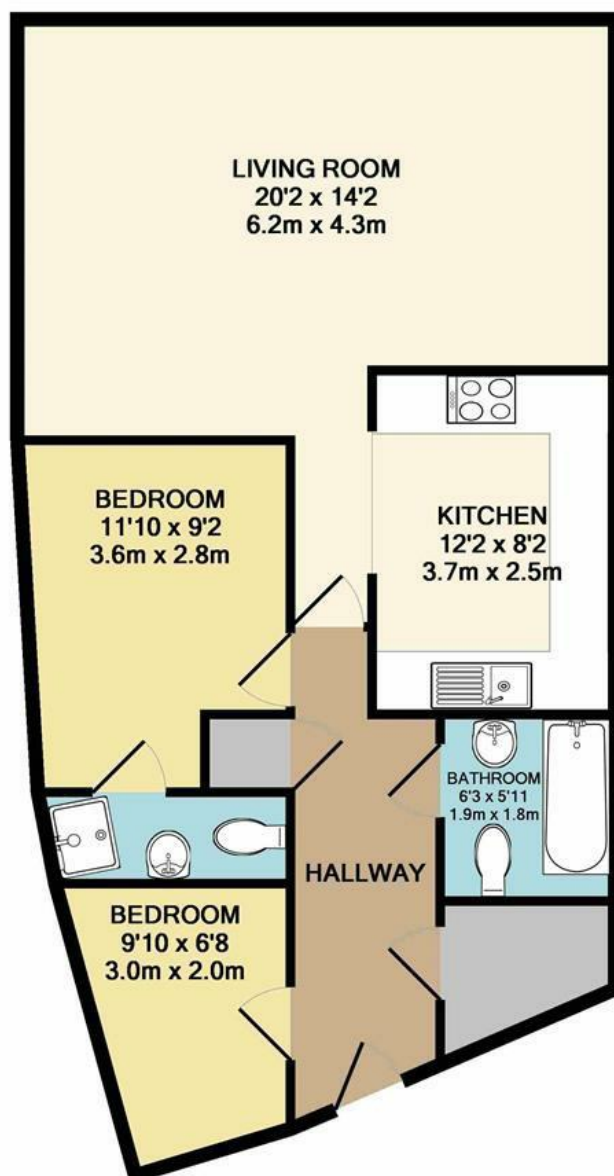

Duke Palace Wharf | Norwich | NR3
 £195,000

abbotFox



TOTAL APPROX. FLOOR AREA 707 SQ.FT. (65.7 SQ.M.)

Whilst every attempt has been made to ensure the accuracy of the floor plan contained here, measurements of doors, windows, rooms and any other items are approximate and no responsibility is taken for any error, omission, or mis-statement. This plan is for illustrative purposes only and should be used as such by any prospective purchaser. The services, systems and appliances shown have not been tested and no guarantee as to their operability or efficiency can be given
 Made with Metropix ©2019

Energy Efficiency Rating		
	Current	Potential
Very energy efficient - lower running costs		
(92 plus) A		
(81-91) B		
(69-80) C	71	78
(55-68) D		
(39-54) E		
(21-38) F		
(1-20) G		
Not energy efficient - higher running costs		
England & Wales	EU Directive 2002/91/EC	

Disclaimer – In accordance with the Property Misdescriptions Act, the company gives notice that all descriptions, references to condition, necessary permissions for use and other details are given in good faith and believed to be correct, but any intending lessees do not rely on them as statements of fact, but must satisfy themselves by inspection or other means, as to their accuracy.

The logo for AbbotFox, featuring the word "abbot" in white and "Fox" in orange, set against a dark blue square background.

abbotFox

abbotFox presents this stylish City Centre apartment. Offering two bedrooms, en-suite to master, family bathroom and generous open plan living with separate kitchen, this home offers a perfect opportunity for any professional couple or investor. Located within the heart of the City and offering a view of the nearby River Wensum, this home demands an internal viewing to be appreciated.

The highly sought after NR3 area of Norwich sits just north of the City Centre, providing a range of amenities such as; shops, public houses, Waterloo Park, restaurants, Hollywood Cinemas and the Anglia Square shopping centre, which has recently been approved for renovation. The vibrant City of Norwich is accessible by foot or a variety of regular bus routes are available including services to the City Centre, University of East Anglia, Norwich & Norfolk Hospital, Attleborough and many more making this location highly convenient for travelling in and around Norwich and the county of Norfolk.